

ГКС-3525

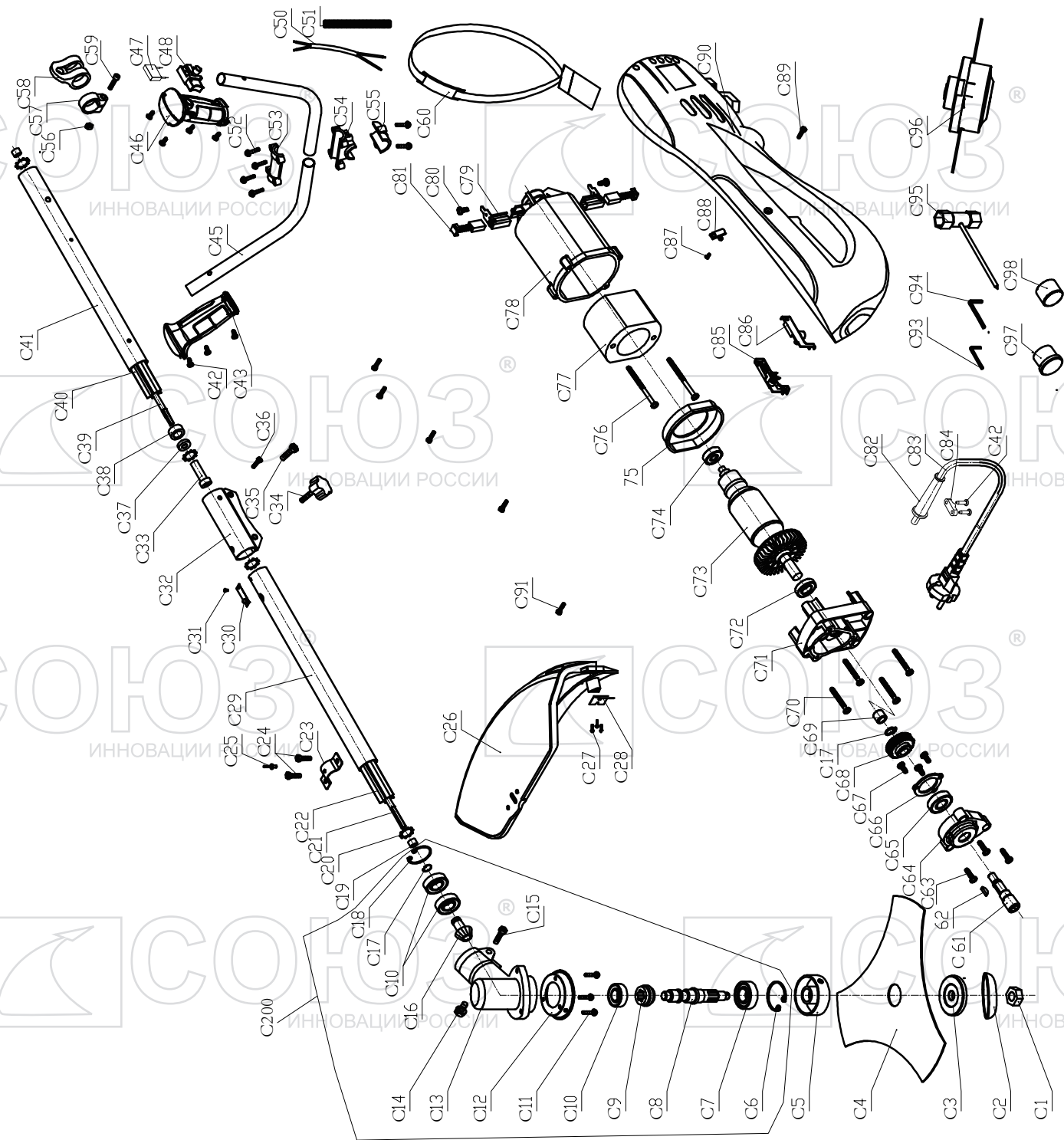

ГКС-3525

NO.	DESCRIPTION	NO.	DESCRIPTION	NO.	DESCRIPTION
C1	left-NUT M10	C34	locking knob	C69	needle bearing HK0810
C2	The blade cover	C35	screw M6*20	C70	Tapping screw ST4*35
C3	down flange	C36	screw M4*10	C71	gear box
C4	blade	C37	Retaining ring	C72	bearing 6901Z
C5	upper flange	C38	screw bush	C73	rotor
C6	circlip \varnothing 32	C39	soft shaft B	C74	bearing 627Z
C7	bearing 6002Z	C40	plastic tube B	C75	wind guide
C8	spindle	C41	steel tube B	C76	Tapping screw ST5*60
C9	big gear	C42	Tapping screw ST4*14	C77	stator
C10	bearing 6000Z	C43	handle	C78	motor housing
C11	screwM5*12	C45	steel tube	C79	carbon brush holder
C12	gear box cover	C46	handle	C80	Tapping screw ST3*8
C13	gear box	C47	capacitor	C81	carbon brush
C14	screwM6*12	C48	Switch	C82	Cable protector
C15	screwM5*25	C50	Spring cable	C83	Cable
C16	pinion shaft	C51	spring cable tube	C84	cable anchorage
C17	circlip \varnothing 10	C52	screw M6*25	C85	right housing cap
C18	circlip \varnothing 26	C53	steel tube press board	C86	lift housing cap
C19	soft shaft limit set	C54	steel tube base	C87	Tapping screw ST3*6
C20	Retaining ring	C55	steel tube base press board	C88	cable clamp
C21	soft shaft A	C56	NUT M5	C89	screw M4*12
C22	plastic tube A	C57	strap hook ring	C90	housing
C23	guard press board	C58	strap hook	C91	Tapping screw ST4*14
C24	screwM6*20	C59	screw M5*20	C93	hex wrench 4mm
C25	rivet \varnothing 4X6	C60	shoulder strap	C94	hex wrench 5mm
C26	guard	C61	output shaft	C95	wrench
C27	blade	C62	Woodruff key	C96	spool assembly
C28	Tapping screw ST4*8	C63	screw ST4*16	C97	Rubber plug
C29	steel tube A	C64	gear box cover	C98	Rubber plug
C30	shrapnel	C65	bearing 6001Z	C200	Gear box assembly
C31	rivet	C66	bearing cover		
C32	connect tube	C67	screw ST4*10		
C33	soft shaft bush	C68	gear		